

Order Codes

Libra Sheath – Prescription

All Libra Sheaths come with a Measuring Guide and 30 Hair Protectors as standard

Code	Style	Size	Quantity
GBLSS24	Standard	24mm	30
GBLSS28	Standard	28mm	30
GBLSS31	Standard	31mm	30
GBLSS33	Standard	33mm	30
GBLSS35	Standard	35mm	30
GBLSS40	Standard	40mm	30
GBLSP24	Pop On	24mm	30
GBLSP28	Pop On	28mm	30
GBLSP31	Pop On	31mm	30
GBLSP33	Pop On	33mm	30
GBLSP35	Pop On	35mm	30
GBLSP40	Pop On	40mm	30
GBLSW24	Wide Band	24mm	30
GBLSW28	Wide Band	28mm	30
GBLSW31	Wide Band	31mm	30
GBLSW33	Wide Band	33mm	30
GBLSW35	Wide Band	35mm	30
GBLSW40	Wide Band	40mm	30



Libra[®] Sheath

Instructions For Use



Great Bear Healthcare Ltd
 1 Lambourne Crescent,
 Cardiff Business Park,
 Cardiff, CF14 5GF
 T +44 (0) 29 2074 7770

mail@gbhl.co.uk
 www.greatbearhealthcare.co.uk



MediReps Ltd
 First Floor, Penrose One,
 Penrose Dock, Cork City,
 T23 KW81,
 Ireland

LIBRASHEATHIFUV5/2022



A UK manufacturer committed to Urology.

Your Libra® Sheath

The Libra Sheath is made from silicone and contains no latex.

The adhesive on the inside is a medical grade adhesive and helps to adhere the sheath to the penis for a safe, comfortable fit.

Instructions For Use

- 1) Wash your hands before use
- 2) Please ensure you are using the correct size and style of sheath – a measuring guide is enclosed for your reference
- 3) If necessary trim the pubic hair or use the hair protectors supplied
- 4) The sheath is supplied individually in a pouch
- 5) The pouch has a perforated edge to allow the sheath to be removed easily
- 6) Tear along the perforation to access the sheath (Diagram 1)
- 7) Remove the sheath from the pack by the spout (Diagram 2)
- 8) Pop On style sheaths have a clear plastic cone (point B on Diagram 3) to protect the sheath in storage. Take the sheath off the cone by holding the sheath just below the spout (point A on Diagram 3) and the plastic cone and gently pull
- 9) Position the sheath over the penis
- 10) If you are using a standard style sheath leave a small space between the end of the penis and the base of the spout
- 11) Unroll the sheath along the shaft of the penis ensuring the end of the sheath is fully unrolled (Diagram 4)
- 12) Place your hand over the shaft of the penis and sheath and gently squeeze – this will allow the adhesive to warm up and ensures a comfortable fit (Diagram 5)
- 13) Fit drainage bag to leg first before connecting to the sheath to avoid any twisting as this may prevent drainage
- 14) Connect your drainage bag to the spout of the sheath making sure the tap on the bag is in the closed position (Diagram 6)

Removal Instructions

- 1) To remove the sheath, release the base of the sheath all the way around
- 2) Use warm soapy water and wash-cloth or use an Adhesive Remover Spray to help ease the sheath off (Diagram 7)

- 3) Dispose of your sheath and wash your hands
- 4) The Libra Sheath should be changed every 24 hours for hygienic purposes but this may vary between users – advice can be sought from your healthcare professional
- 5) Please note: if your skin becomes irritated whilst using this product, do not use until you have spoken to your healthcare professional

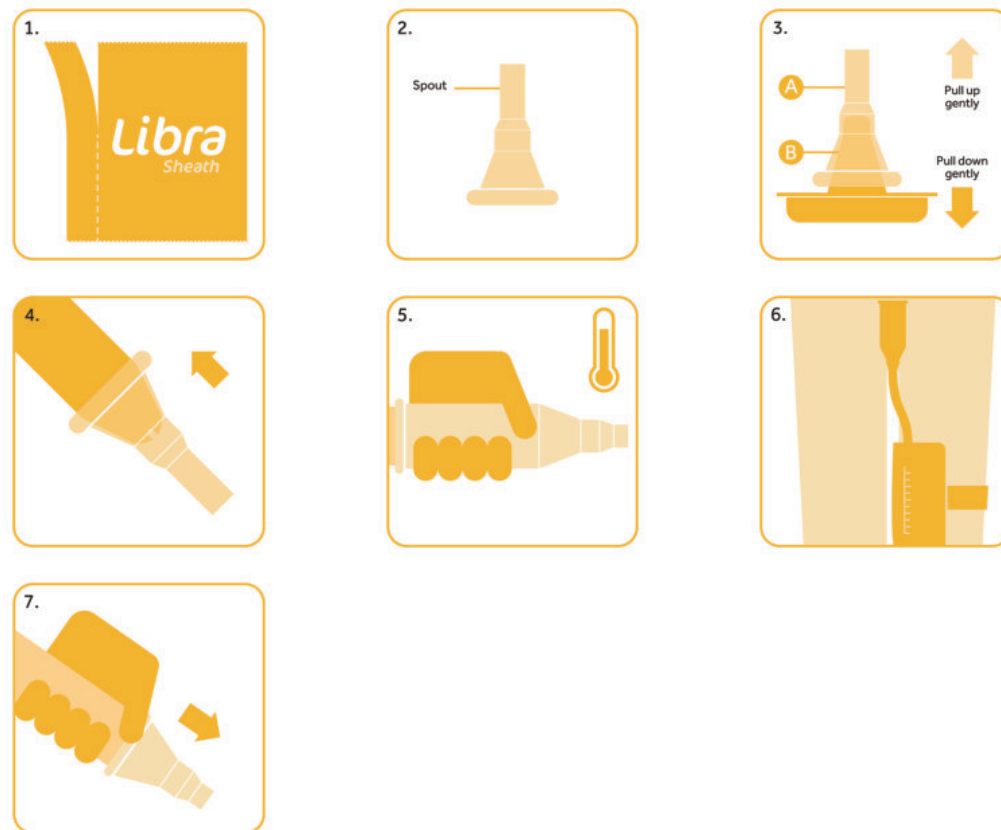

Cautions

- Use of any medical device carries associated risks. Device failures are rare, however in the event of a device failure of this product, you should contact Great Bear Healthcare using the details provided within this leaflet
- If a failure has resulted in a serious incident, such as significant deterioration of health or death, you should contact Great Bear Healthcare and your local Competent Authority as soon as possible. Details of your local Competent Authority can be found on your local government website